

# 525,000

**STONEWOOD**  
HOMES

Lot 201 Yaldhurst Park, Christchurch



## For Sale

House and Land Package

Dwelling Size	Section Size				
150m <sup>2</sup>	415m <sup>2</sup>	3	1	2	2

**Titled due September 2021 completed April 2022**

This home features three bedrooms, master with ensuite and walk-in robe, open plan kitchen living and dining, family bathroom and internal access double garaging. Well appointed for the sun on an easy section with driveway and patio, offering quality fixtures and fittings throughout and finished to a high standard this design is sure to impress.

Just west of the city Yaldhurst Park is the perfect combination of town meets country. Christchurch's western region has long been a desirable place to live, stretching out towards the Southern Alps. Situated off Yaldhurst Road, it allows a direct get-away out of Christchurch to the myriad of ski fields located west of Christchurch, to fishing and boating rivers, and numerous other recreational reserves, and is the ideal setting for anyone who loves to be surrounded by nature. Within walking distance the subdivision offers cafes and restaurants with the retail precinct.

0800 86 00 00

[www.stonewood.co.nz](http://www.stonewood.co.nz)

# Lot 179 Yaldhurst Park, Christchurch

- |                              |                         |                                |
|------------------------------|-------------------------|--------------------------------|
| Quality cladding selections  | Metal pressed tile roof | 2.42m ceiling height           |
| 1.98m internal door height   | Windsor door hardware   | Designer kitchen               |
| Bosch appliances             | Italian tapware         | LED light fittings             |
| Boundary fencing included    | 8.0kw heatpump          | Hard landscaping               |
| Progressive payment contract | After care service      | 10 year Master Build guarantee |

## Floor Plan:

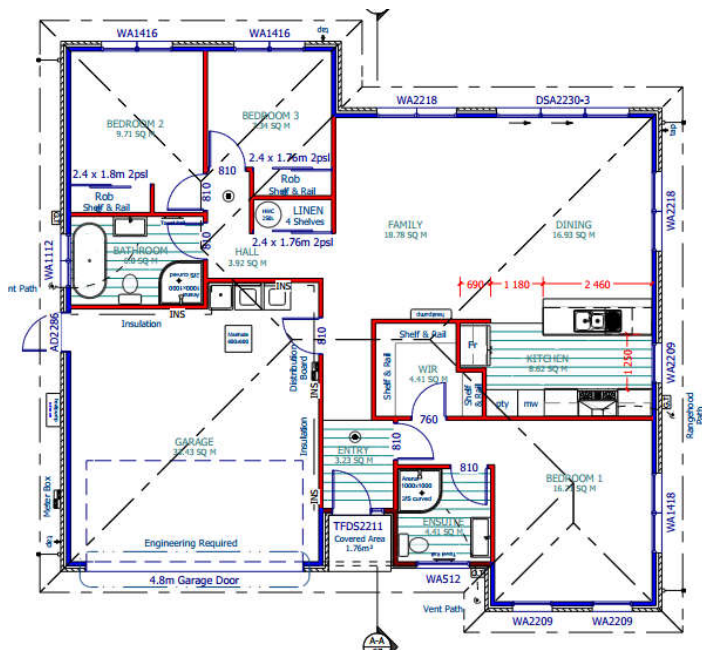

## Location:



**Disclaimer:** This material is for the use of illustrative and guidance purposes. All efforts have been made by Stonewood Homes Christchurch to ensure the information correctly illustrates the dwelling however Stonewood Homes accept no responsibility for any variances which may become apparent once the build commences.

0800 86 00 00

[www.stonewood.co.nz](http://www.stonewood.co.nz)